

# CERTIFICATE OF LOCATION OF GOVERNMENT CORNER

# 4 MEANDER Corner of Section 25, Township 107 N., Range 39 W., 5th. P.M.

STATE OF MINNESOTA, County of MURRAY

At the corner location shown on the sketch:

- On \_\_\_\_\_ found a \_\_\_\_\_
- left monument as found,  lowered monument,  removed monument (explain)
- On 9-17-85 placed a 1 1/4" x 1 1/4" x 20" PERFORATED STEEL TUBE WITH ALUMINUM CAP STAMPED "D.N.R. SURVEY MARKER", UP 0.2'

### SKETCH OF REFERENCE TIES

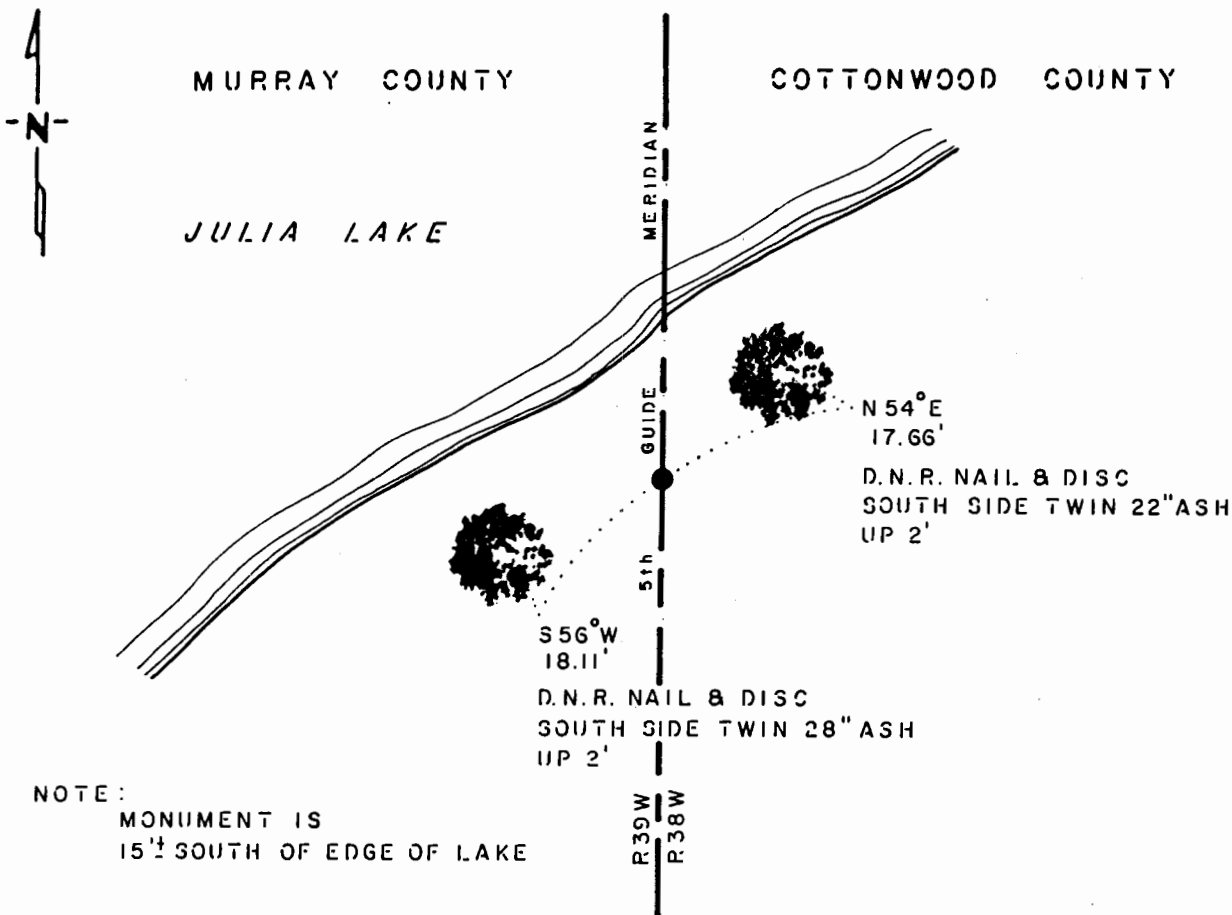

NOTE: MONUMENT IS 15' SOUTH OF EDGE OF LAKE

BEARINGS OBSERVED WITH COMPASS

Statement of evidence relative to this corner location is on back of page.

J. B. M. 10-30-85  
G-1181

I hereby certify that this document and the data contained herein was prepared by me or under my direct supervision.

Lowell R. Pomeroy Jr. 11-7-85  
SIGNATURE DATE

Registration No. 17005

- Land Surveyor,  Professional Engineer
- County Surveyor,  County Engineer

### OFFICE OF THE COUNTY RECORDER

County of \_\_\_\_\_

I hereby certify that this document was filed in the Co. Recorders office at \_\_\_\_\_ M. on the \_\_\_\_\_ day of \_\_\_\_\_ A.D., 19 \_\_\_\_\_

County Recorder \_\_\_\_\_

By \_\_\_\_\_, Deputy

DOCUMENT NO. \_\_\_\_\_

Meander Corner #4 of Section 25, Township 107 North, Range 39 West

This corner was originally established by the U. S. General Land Office in 1857. The government notes show corner marked with a wood post with the following bearing trees marked:

- 7" Willow, South 80° West, 10 links (6.6 ft.)
- 6" Black Ash, South 2° East, 7 links (4.62 ft.)

In March 1985, the DNR Bureau of Engineering contacted the following for corner information:

- Murray County Offices of the Recorder and Highway Engineer
- Cottonwood County Offices of the Recorder and Highway Engineer
- Mn/Dot Office in St. Paul
- U.S. Dept. of the Interior, Fish and Wildlife Office in Minneapolis
- Land Surveying Firms:
  - Martin Land Surveying of Worthington
  - Madsen Land Surveyors of Fairmont
  - Sioux Engineering of Windom

No resurvey information was obtained for this corner.

In March 1985, the DNR Bureau of Engineering traversed to the area of the corner and searched for but did not find the wood post or bearing trees marked by the GLO. Computed a lost position for this corner using the northeast corner of Section 36 and the east quarter corner Section 24. Lost position was found to measure:

- 5085.19 ft. from the northeast corner of Section 36
- 2819.25 ft. from the east quarter corner of Section 24

In July 1985, searched at the lost position and found it to be at top of Lake bank, 10 ft. south of water's edge. No evidence of the corner was found.

Accept the lost position as the location of the corner.

Traverse information is available from the DNR Bureau of Engineering.

sln32/cors